

GENERAL NOTES

1. Do not scale. If in doubt ask.
2. All dimensions are in millimetres unless noted otherwise.
3. The design shown on this drawing is the property of LBD and is not to be used or in part, except in accordance with or disclosed, in whole or in part, except in accordance with a contract, license or agreement in writing with LBD.
4. All works to be executed in accordance with current British Standards, Codes of Practice, current Building Regulations associated amendments current to the lodging of the application and to the satisfaction of the Building Control Officer.
5. Where relevant, works to be in accordance with manufacturers requirements and specifications.
6. All works to be implemented in accordance with current Health and Safety legislation inclusive of protective works, and all works to be implemented in accordance with the current Building Regulations and associated amendments current to the lodging of the application and to the satisfaction of the Building Control Officer.
7. No works to take place until Main Contractor has been issued with Building Control approval in place for all Civil & Structural engineering elements.

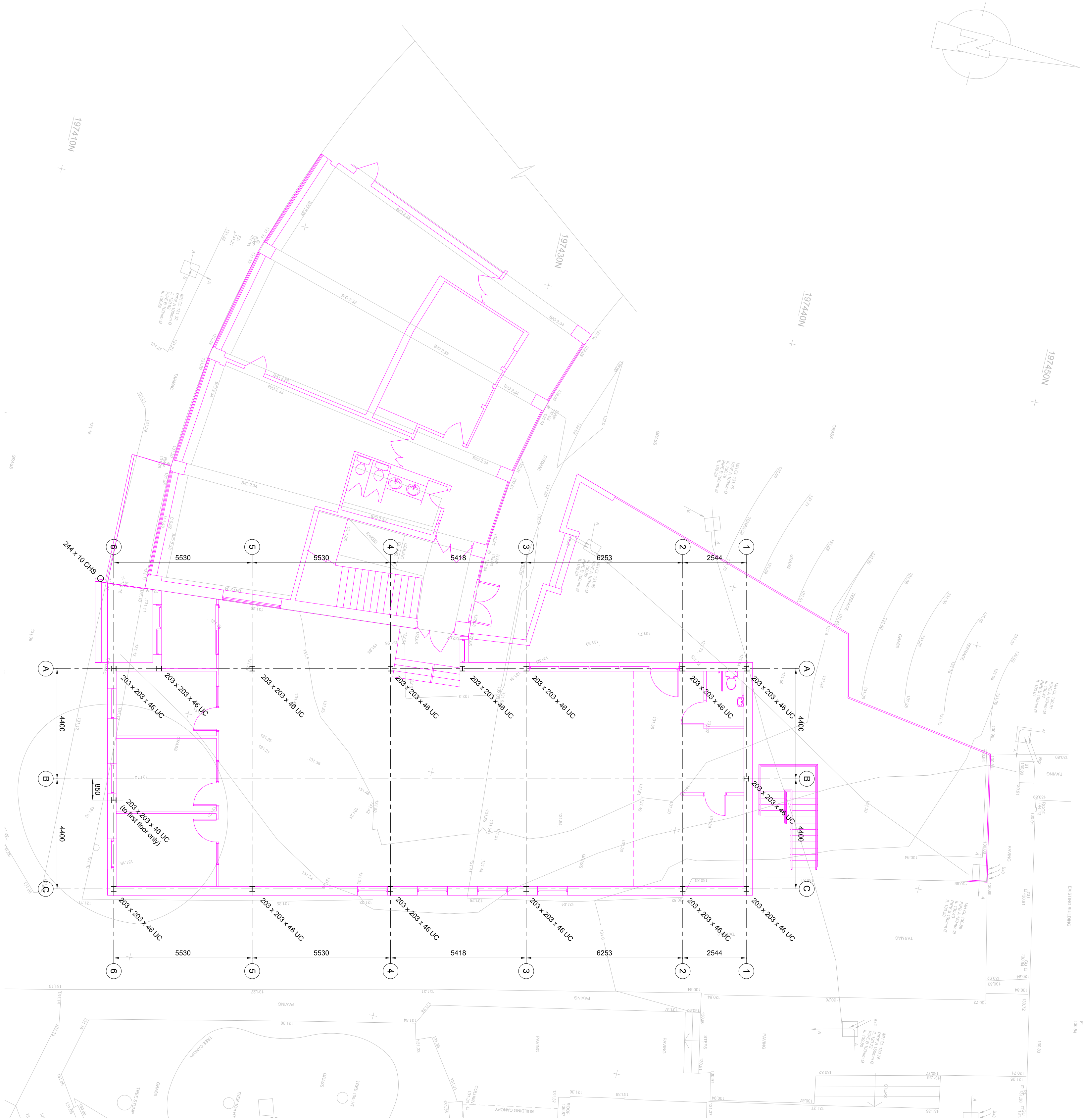

**lindsay baxter design ltd**  
consulting civil & structural engineers  
Tel: 01924 2715 585 www.lindsaybaxter.co.uk

**Project:**  
Proposed extension  
Dr Chaloner's School

**Title:**  
External works, levels, drainage and  
Foundations

**Project No:** 1369 **Dwg No:** EW01 rev 0  
**Date:** Dec 2019 **Sheet Size:** A1  
**Drawn:** LJB **Scale:** 1:100